

## GT Maloja

### Geluidsabsorptie

Norm	NEN-EN 1793-1
Categorie	A3
Wegzijde	DL $\alpha$ 9 dB
Spoorzijde, goederen < 50%	$\Delta L_{A,\alpha,Rail}$ 11 dB
Spoorzijde, goederen > 50%	$\Delta L_{A,\alpha,Rail}$ 9 dB

### Afmetingen\*

Breedte in mm	600
Lengte in mm	1000
Totale dikte in mm	100
Gewicht, ca. kg/m <sup>2</sup>	70

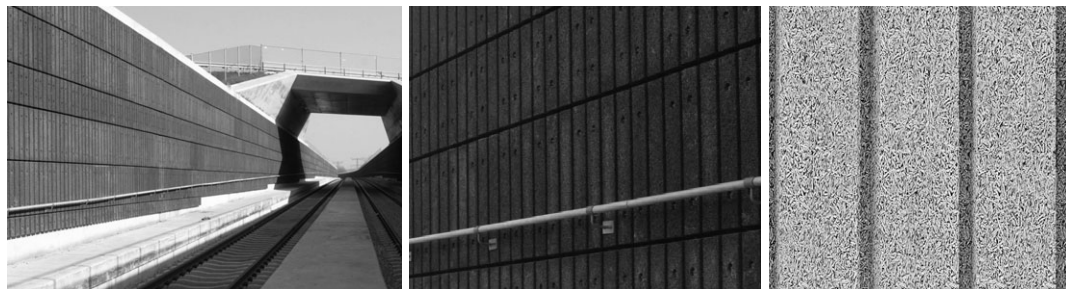
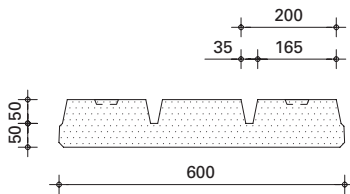

### Weg- of spoorzijde

Materiaal	Houtvezelbeton
Basisdikte in mm	50
Profiel	in lengterichting
Hoogte in mm	50
Moduul in mm	200
Cement	CEM III A 42.5 (grijs) of CEM I 42.5 (wit)
Pigment	geen of in standaard kleur
Coating	geen of waterafstotende coating in RAL-kleur na montage

\* andere afmetingen in overleg mogelijk

3'06

# Details: GT Maloja

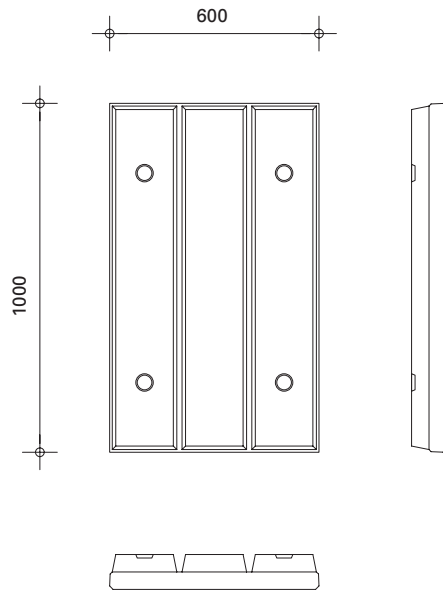

1

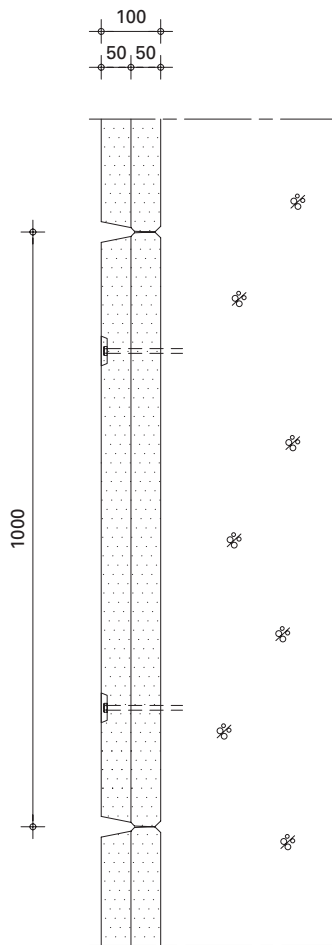

2

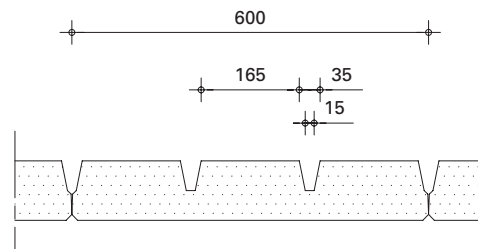

3

